



PRODUCT INFORMATION

The SB184C cinema subwoofer loudspeaker system uses a high power 18-in cone transducer mounted in an optimally vented enclosure to fill small to medium capacity theaters with high definition sub bass information at earth-shaking output levels.

The SB184C's optimally vented enclosure uses enclosure resonance to increase sub bass response while limiting driver excursion. This method produces less distortion and minimizes driver strain while extending sub bass response to the lower limits of human hearing. Special effects will have greater clarity, greater power and greater impact.

A two-terminal barrier strip, which accomodates bare wire, tinned leads or spade lugs, is located on the side of the enclosure for convenient access in cramped installation areas.

The use of multiple SB184C's provides even greater output capability and further extends low frequency response. The enclosure features a textured black finish to eliminate the reflection of light through perforated cinema screens.

COMPONENTS & CONSTRUCTION

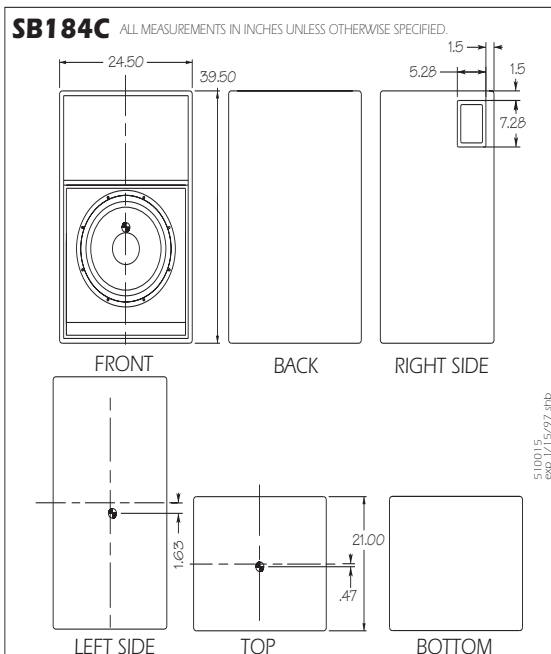

The SB184C is a high output, extended bandwidth subwoofer optimized specifically for cinema use. It features a high power 18-in low frequency transducer mounted in an optimally vented enclosure.

The enclosure is constructed of 3/4-in Medium Density Fiberboard except for the baffle plate which is 15mm, void-free, cross-grain-laminated birch plywood. Extensive internal bracing is employed to minimize panel resonances resulting from the large acoustical energies generated within the enclosure and maximize acoustical energy transfer.

Input connectors are 2-terminal barrier strip, designed to accommodate bare wire, tinned leads or spade lugs.

DESCRIPTIVE DATA

Sub Subsystem & Loading	1x 18-in vented
System Crossover	300 Hz max
Recommended High-Pass Frequency (24 dB/Octave)	20 Hz
Cabinet Type (shape)	Rectangular
Enclosure Materials	3/4-in MDF; 15mm birch baffle
Finish	Textured Black
Connectors	2-terminal barrier strip
Grill	Vinyl Coated Perforated Steel

NOMINAL DATA

Frequency Response		
±3 dB	34 Hz - 500 Hz	
Axial Sensitivity (dB SPL, 1 Watt @ 1m)		
	96	
Impedance (Ohms)		
	8	
Power Handling, AES Standard (Watts)		
	800	
Maximum Output (dB SPL @ 1m)		
Peak	128	
Long Term	125	
Dimensions	Inches	Centimeters
	Height	39.5 100.3
	Width	24.5 62.2
Weights	Pounds	Kilograms
	Net Weight	95 43.2
	Shipping Weight	105 47.8

